

a. \_\_\_\_\_

remove the light using a security torx T1 screw.

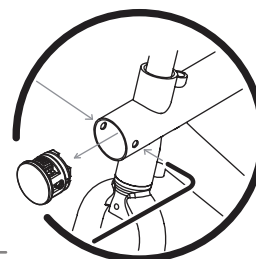

b. \_\_\_\_\_

make sure all the connectors are connected as shown at the right. Red should be connected to the plus connector.

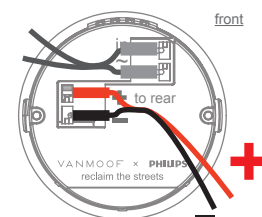

c. \_\_\_\_\_

make sure all the connectors are connected as shown at the right. Red should be connected to the plus connector.

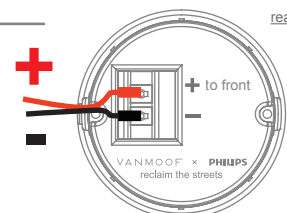

d. \_\_\_\_\_

always use pliers to connect and disconnect the connectors. otherwise you risk breaking the connection between wire and connector. Use voltmeter to determine defects in the wire.

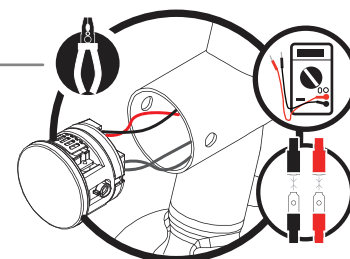

e. \_\_\_\_\_

the rear light is not working properly. Replace by a new rear light. Make sure to connect the wires properly as shown at c.

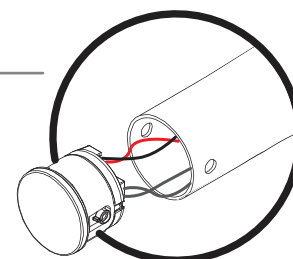

f. \_\_\_\_\_

the front light is not working properly. Replace by a new front light. Make sure to connect the wires properly as shown at b.

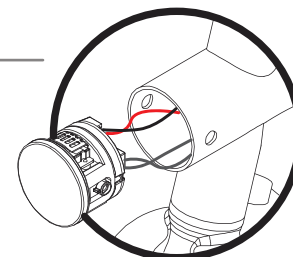

g. \_\_\_\_\_

unscrew the switch carefully. disconnect the wires of the switch at the front light as shown at F. Insert new switch and reconnect the wires as shown on page 3.

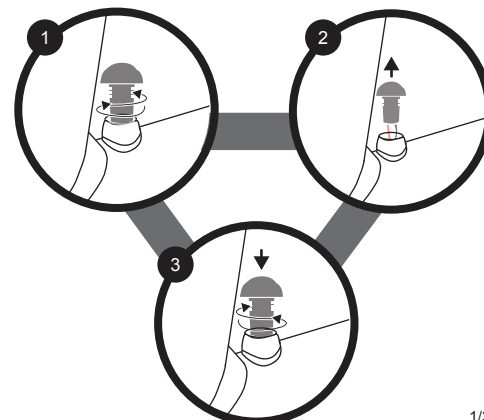

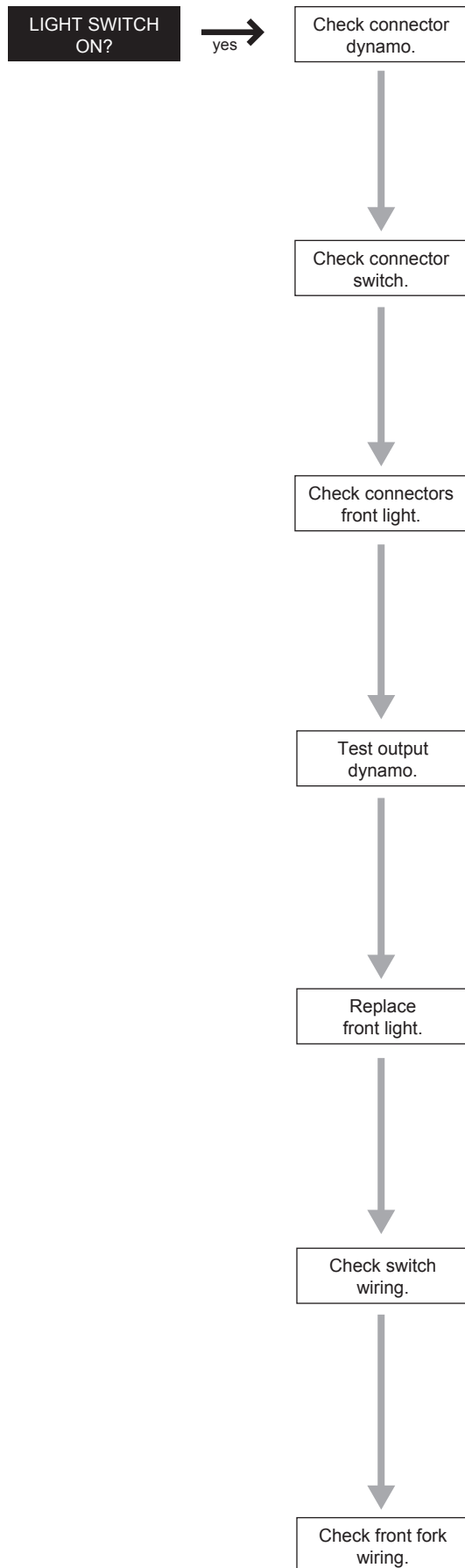

h. \_\_\_\_\_

the wires should be connected as shown here.

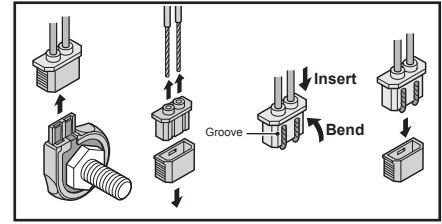

i. \_\_\_\_\_

possibly the connector of the switch has come loose. Check the switch, follow the steps as described at G.

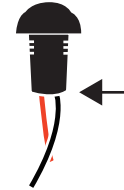

j. \_\_\_\_\_

make sure all the connectors are connected as shown at the right. Red should be connected to the plus connector.

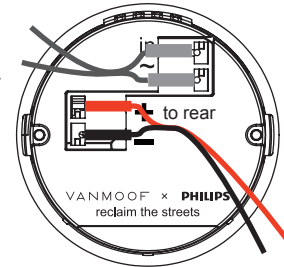

k. \_\_\_\_\_

use a voltmeter to check if the dynamo is working properly.

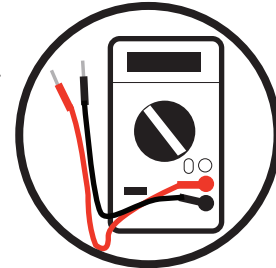

l. \_\_\_\_\_

the front light is not working properly. Replace by a new front light. Make sure to connect the wires properly as shown at b.

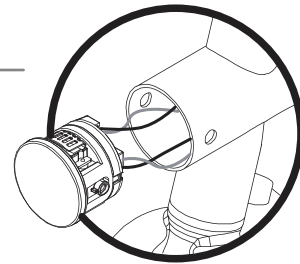

m. \_\_\_\_\_

use a voltmeter to check if the wire is transmitting current as it should, otherwise replace the switch and its wire as described at G.

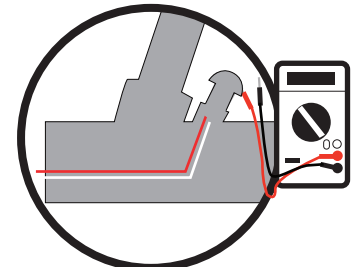

n. \_\_\_\_\_

use a voltmeter to check if the wiring from dynamo to front light is transmitting current.

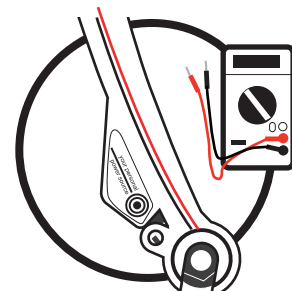

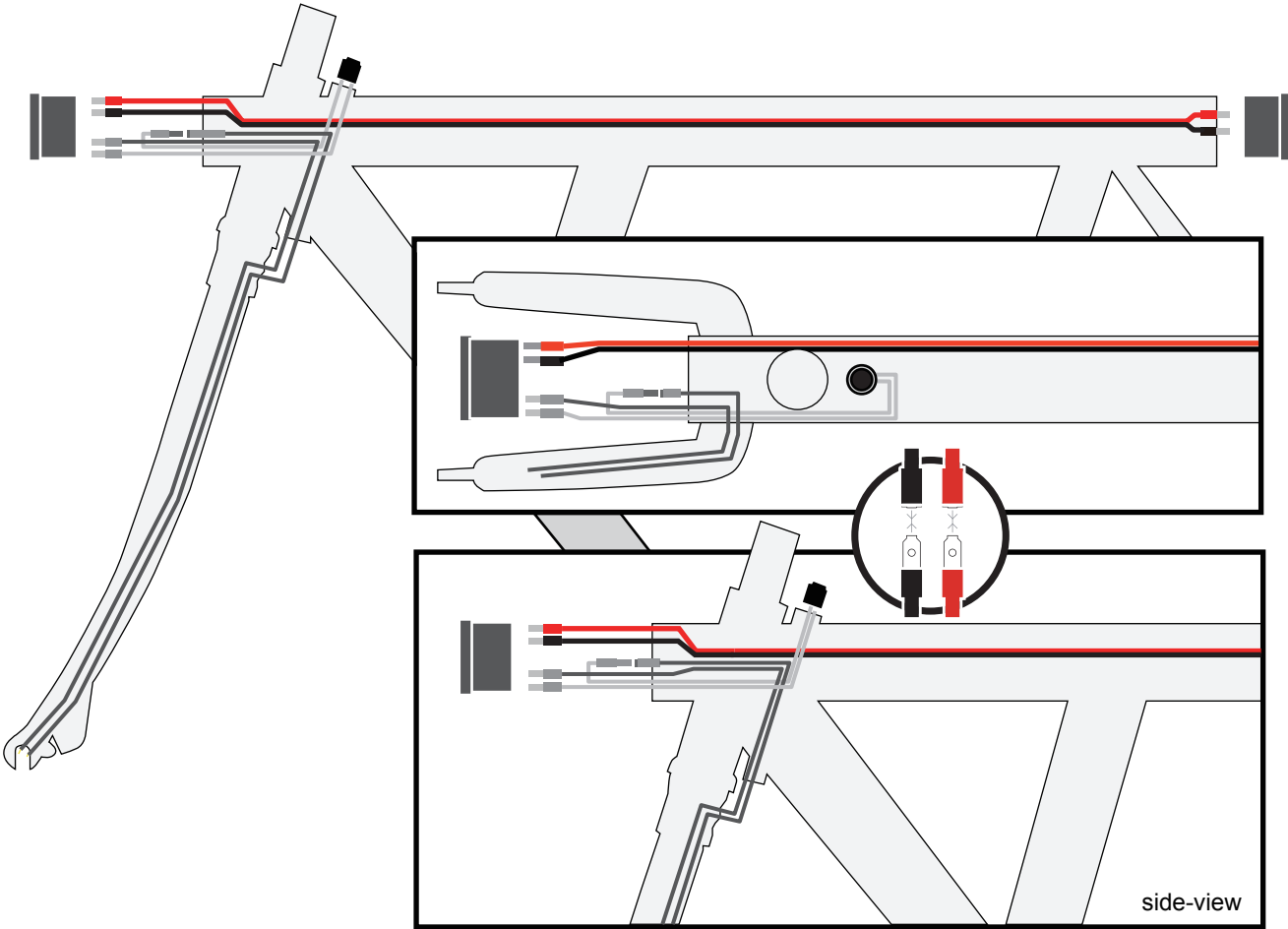

TOPTUBE CABLESET

**note:** red is positive, black is negative, make sure to connect the cable to the appropriate connector as shown on the back of both lightsets



SWITCH CABLESET



FORK CABLESET

